

Completed Photo

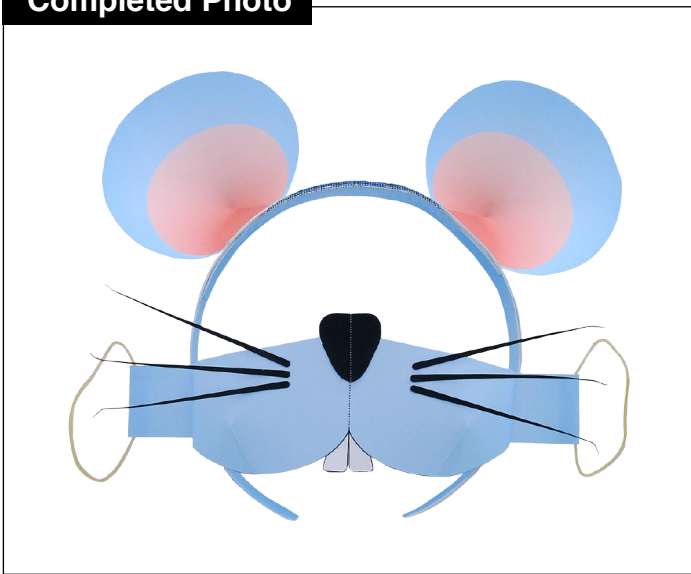

■ **You will need:** Scissors, glue, ruler, a used ball-point pen, rubber bands

■ **Explanation of symbols:**

- Mountain fold
- - - - - Valley fold
- Cut line
- Glue tab
- Cut in line

■ **Assembly tip:** Trace along the folds with a ruler and a used pen (no ink) to get a sharper, easier fold.

Caution: This craft requires the use of glue, scissors, and other tools which may be dangerous to young children. Please keep them out of reach of children while you work.

HOW TO MAKE

1. Assemble the parts that will become the inner frame (parts A and B).

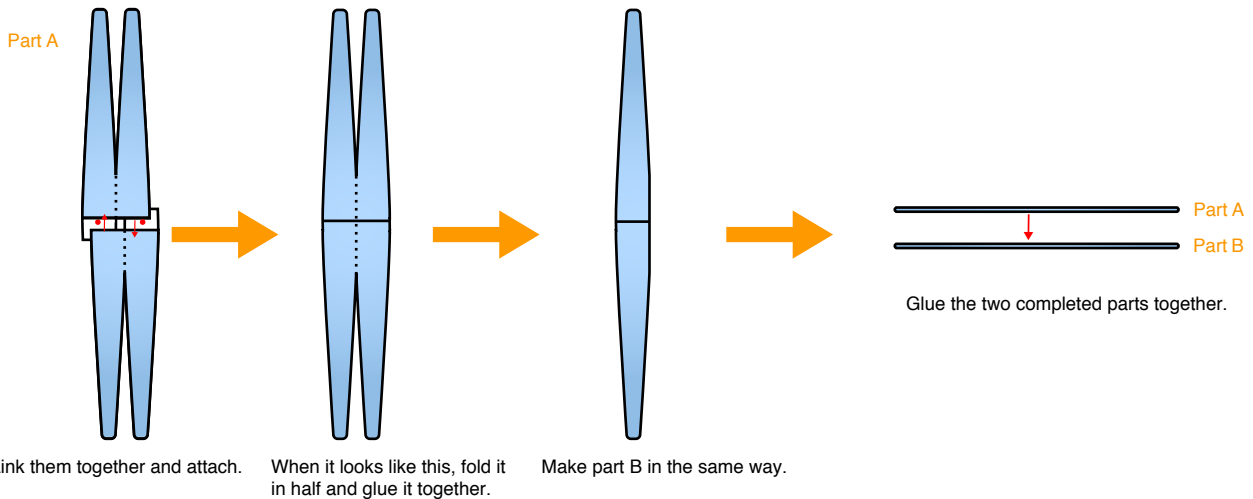

2. Make the inside part of the headband.

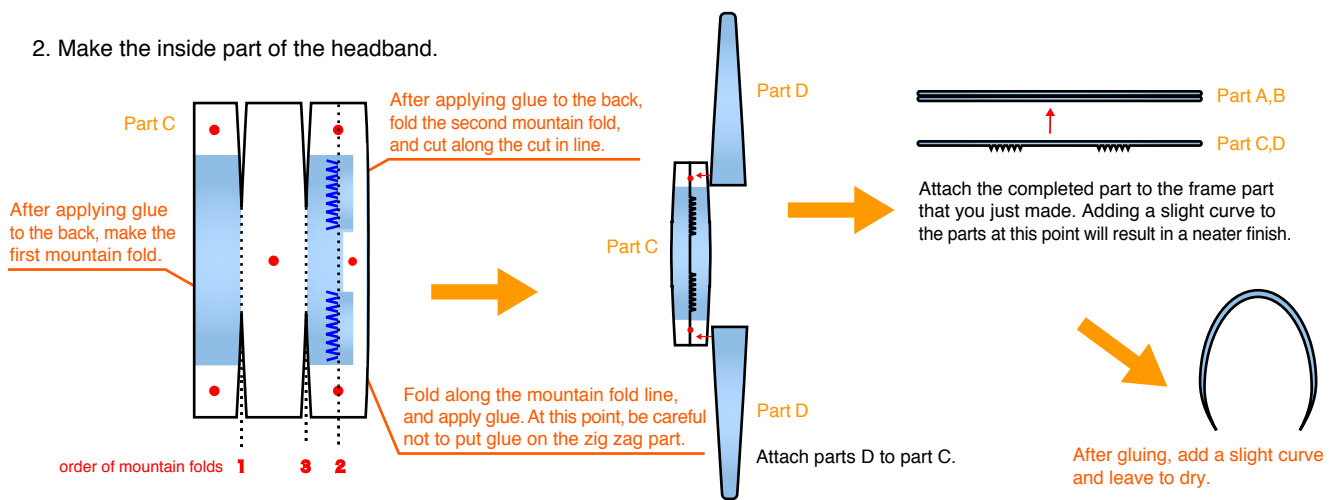

HOW TO MAKE

3. Make the outside part of the headband (ears).

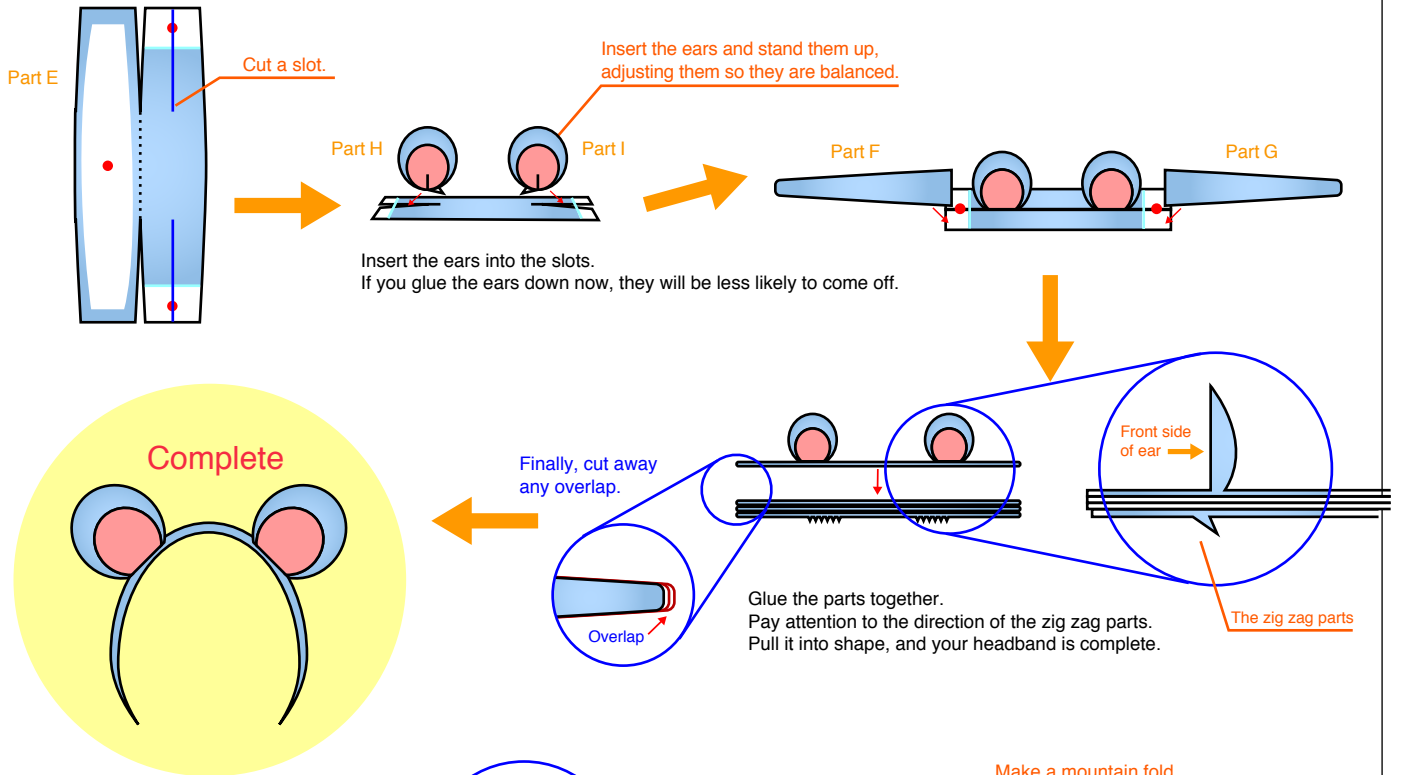

4. Make the nose.

