

Heather Bailey™

Flower Pinwheel

Paper Toy



Flower Pinwheel Paper Toy

Hearken back to yesteryear with Heather's layered, floral pinwheels -- perfect for gifts, decorations, party favors, and fun!

Read through all instructions before beginning.

Materials List:

- 7" x 7" double-sided cardstock - two pieces
- cardstock scraps for pinwheel center
- decorative brad or button
- two 1/8"-3/16" eyelets
- 12" wire, 18 gauge
- wood bead, 1/2"-5/8" in diameter
- 18" wood dowel, 5/16"-3/8" in diameter
- acrylic paint for dowel (optional)
- 1 yd. ribbon, 1/4"-3/8" w (optional)
- craft glue

Helpful Tools:

xacto knife, drill with 3/32" bit, 1/8" hole punch, various flower punches, 1" circle punch, eyelet tool (plier-style best), wire cutter, pencil

1. Cut Out - Cut out pinwheel pattern. With pencil, trace lightly around pattern onto each cardstock piece. Cut out pinwheel pieces. Punch a hole at center of each pinwheel piece as well as at each black circle on pinwheel spokes. Cut two circles from cardstock scraps, 1" in diameter. Punch a hole at center of one circle.

2. Form Flower Wheel - Layer two pinwheel pieces together face up. Twist pinwheel pieces to nest/lock together with spokes on top. Glue together at center only. Attach eyelet at center, through all layers. Moving in a clockwise direction, bring each spoke to center one at a time, layering each spoke onto an eyelet as you go. Once all spokes are stacked on eyelet, arrange spokes evenly, and set eyelet to hold spokes together.

3. Prep Dowel - Paint dowel. Drill hole through dowel, 1/2" from one end. Wrap ribbon around dowel, gluing as needed. Secure ribbon ends with glue.

4. Form Spindle - Bend wire 90°, 3/8" from one end. Slide hole-punched circle onto wire. Sandwich bent end of wire between punched circle and unpunched circle. Glue together enclosing bent end of wire to form center of spindle. Create a layered flower using various flower punches and a brad. Glue to center of spindle -- or simply glue a button at center.

5. Assemble Parts - Slide flower wheel onto spindle. Add wooden bead. Next, feed wire into hole in dowel. Position wire so there is an extra 1/4" of wire beyond flower wheel and wooden bead -- this space helps the pinwheel spin freely. Wrap remaining wire tightly several times around dowel. Trim wire if needed.

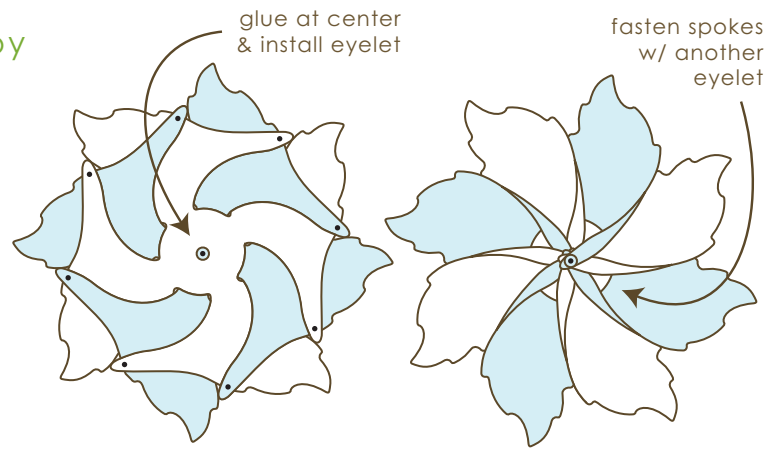

Step 2

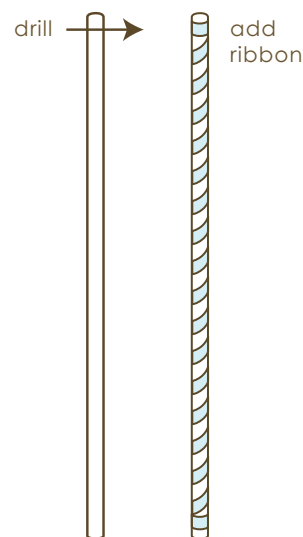

Step 3

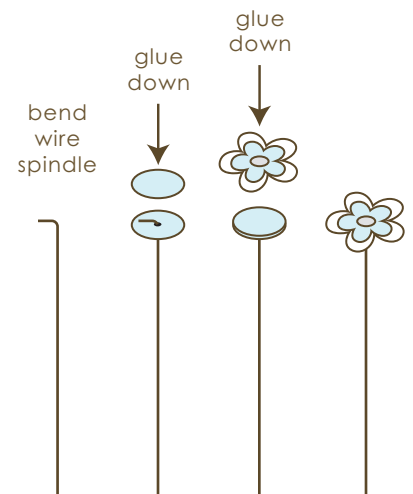

Step 4

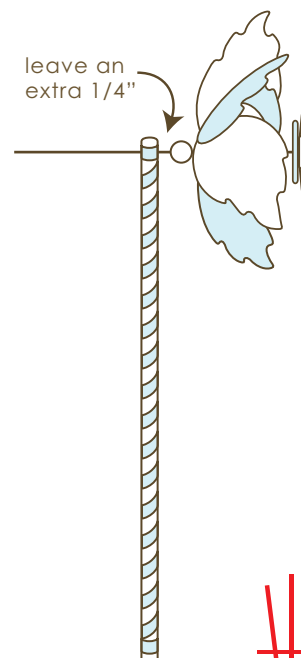

Step 5

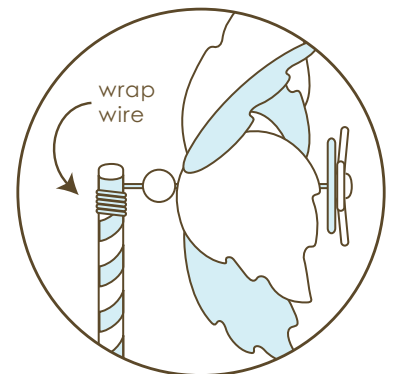

www.HELLOmynameisHeather.com

© 2008 Heather Bailey • DO NOT DUPLICATE
• free pattern download • not for resale

Flower Pinwheel Paper Toy

